

FOR LEASE



CLIFF AVENUE PLAZA

RETAIL / OFFICE SPACE

Bender
COMMERCIAL

 **5008 SOUTH CLIFF AVENUE
SIOUX FALLS, SD**

 **1,750 SF**

**\$ \$16.00/SF NNN
EST NNNs: \$5.73/SF**

- Retail/Office space located in Cliff Avenue Plaza along high traffic Cliff Avenue near 57th Street.
- Flexible floorplan to accommodate user's needs.
- In-suite restroom.
- Building and monument signage available.
- Parking ratio of 1:185.
- Great visibility with a daily traffic count of 17,800 vehicles along Cliff Avenue.
- \$20.00/SF tenant improvement allowance with acceptable lease.

ANDI ANDERSON, SIOR | andi@benderco.com | 605-782-1660



Bender Commercial Real Estate Services | 305 West 57th Street | Sioux Falls, SD 57108 | 605-336-7600 | benderco.com

© 2024 Bender Companies. Information herein deemed reliable, but not guaranteed.

CLIFF AVENUE PLAZA



OFFICE / RETAIL SPACE FOR LEASE

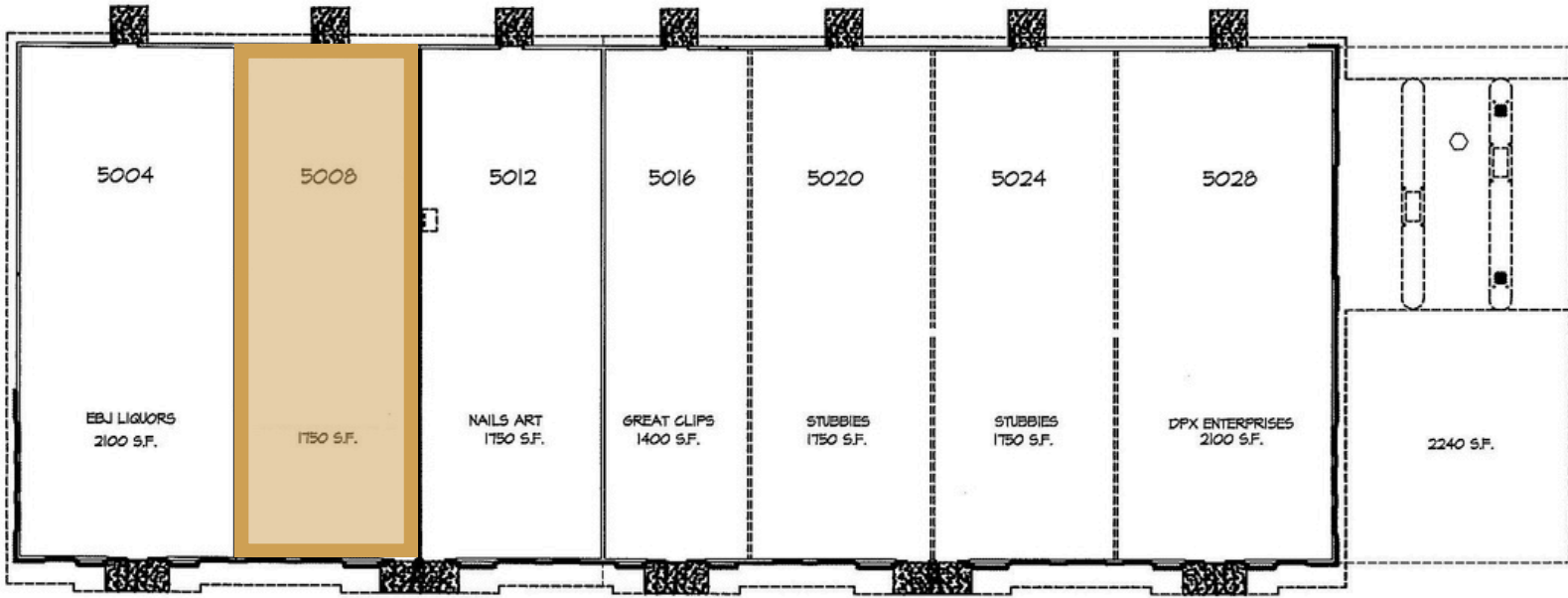

CLIFF AVENUE PLAZA



OFFICE / RETAIL SPACE FOR LEASE



CLIFF AVENUE PLAZA



OFFICE / RETAIL SPACE FOR LEASE

DEMOGRAPHIC SUMMARY

5008 S Cliff Ave, Sioux Falls, South Dakota, 57108 2

Ring of 2 miles

KEY FACTS

33,882

Population



14,145

Households

41.9

Median Age

\$81,521

Median Disposable Income

EDUCATION

3%

No High School Diploma



19%

High School Graduate



28%

Some College



51%

Bachelor's/Grad/Prof Degree

INCOME



\$99,723

Median Household Income



\$52,969

Per Capita Income



\$289,794

Median Net Worth

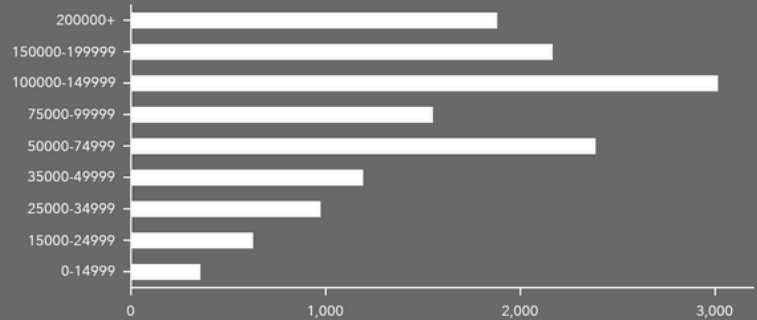

HOUSEHOLD INCOME

EMPLOYMENT



82%

White Collar



11%

Blue Collar



8%

Services

2.8%

Unemployment Rate

Source: Esri. The vintage of the data is 2022, 2027.