

FOR LEASE



CHEROKEE STREET WAREHOUSE SPACE

Bender
COMMERCIAL



**1217 & 1219 WEST CHEROKEE STREET
SIOUX FALLS, SD**



2,500 - 18,000 SF



**\$5.00/SF
GROSS**

- Warehouse space located in the Airport Industrial Park.
- Trench drains.
- Each bay has two (2) 14' overhead drive-thru doors.
- 3-Phase 480v power.
- Landlord willing to improve space to fit tenant's needs.
- Bays can be leased together or separately.
- Easy access to Russell Street and I-29.

ALEX SOUNDY, SIOR | alex@benderco.com | 605-376-3700



Bender Commercial Real Estate Services | 305 West 57th Street | Sioux Falls, SD 57108 | 605-336-7600 | benderco.com

© 2024 Bender Companies. Information herein deemed reliable, but not guaranteed.

CHEROKEE WAREHOUSE SPACE



WAREHOUSE SPACE FOR LEASE



CHEROKEE WAREHOUSE SPACE



WAREHOUSE SPACE FOR LEASE

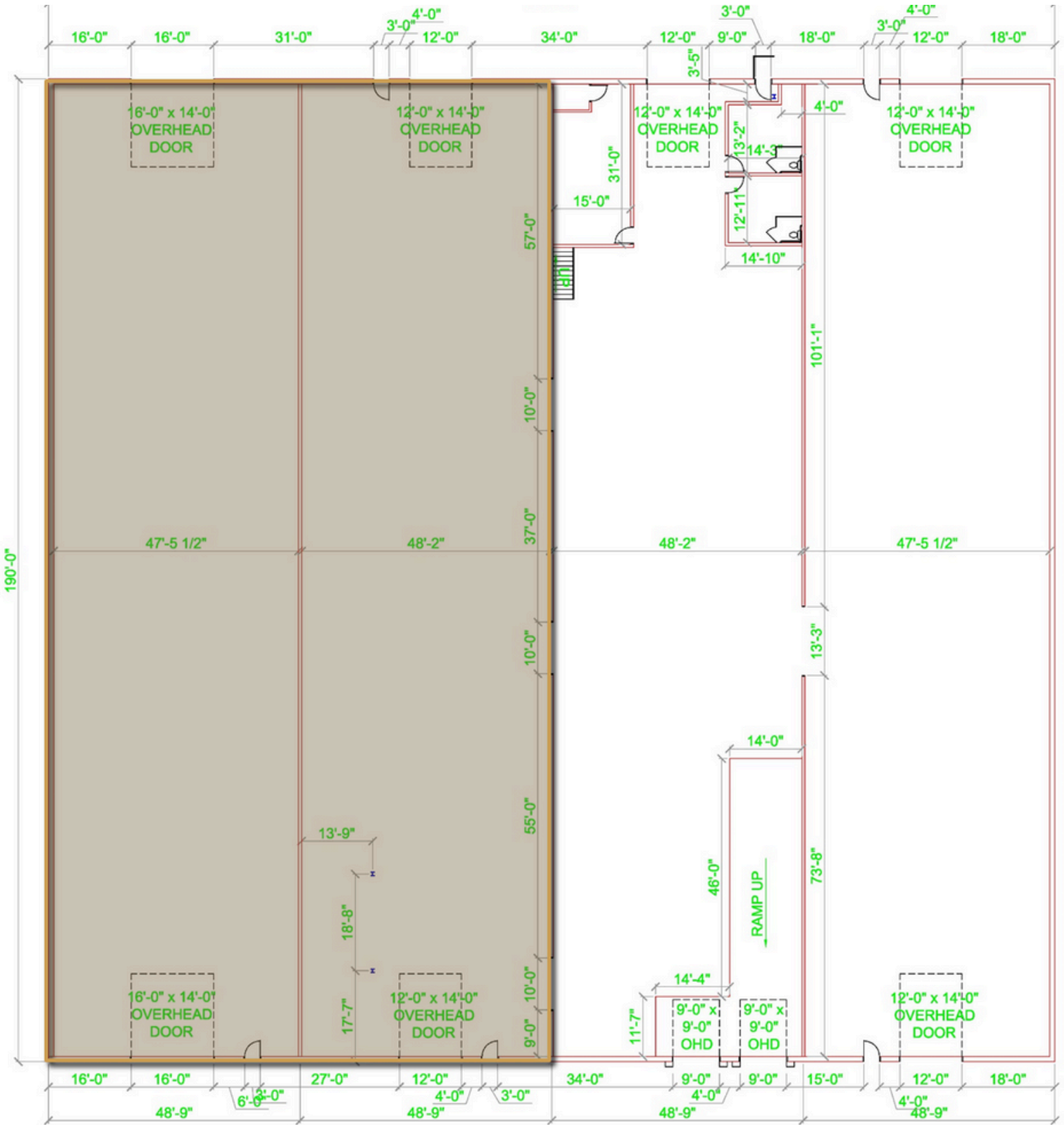

CHEROKEE WAREHOUSE SPACE



WAREHOUSE SPACE FOR LEASE

