

FOR SALE



MAPLEVIEW LAND

LIVE-WORK & MULTI-FAMILY/TWINHOME LAND

Bender
COMMERCIAL



**LEUCADIA TRL & PADDINGTON ST
SIOUX FALLS, SD**



**9.43 ACRES
SUBDIVIDABLE**



\$ \$6.00 - \$9.00/SF

- Live-Work and Multi-Family/Twinhome land located near South Veterans Parkway in quickly developing east Sioux Falls.
- 1.22 acres - LW Live-Work - \$9.00/SF
- 4.99 acres - RA-1 Residential (multi-family) - \$8.00/SF
- 3.22 acres - RD-1 Residential (twinhome) - \$6.00/SF
- Access to city utilities.
- Property to be delivered rough-graded and build-ready.
- Located 1/2 mile from Madison Street, 3 miles from I-90 and 1.5 miles from Dawley Farm.

ROB KURTENBACH

rk@benderco.com

605-940-0559

REGGIE KUIPERS, SIOR

reggie@benderco.com

605-496-2966



Bender Commercial Real Estate Services | 305 West 57th Street | Sioux Falls, SD 57108 | 605-336-7600 | benderco.com

© 2024 Bender Companies. Information herein deemed reliable, but not guaranteed.

MAPLEVIEW LAND



LIVE-WORK & MULTI-FAMILY/TWINHOME LAND

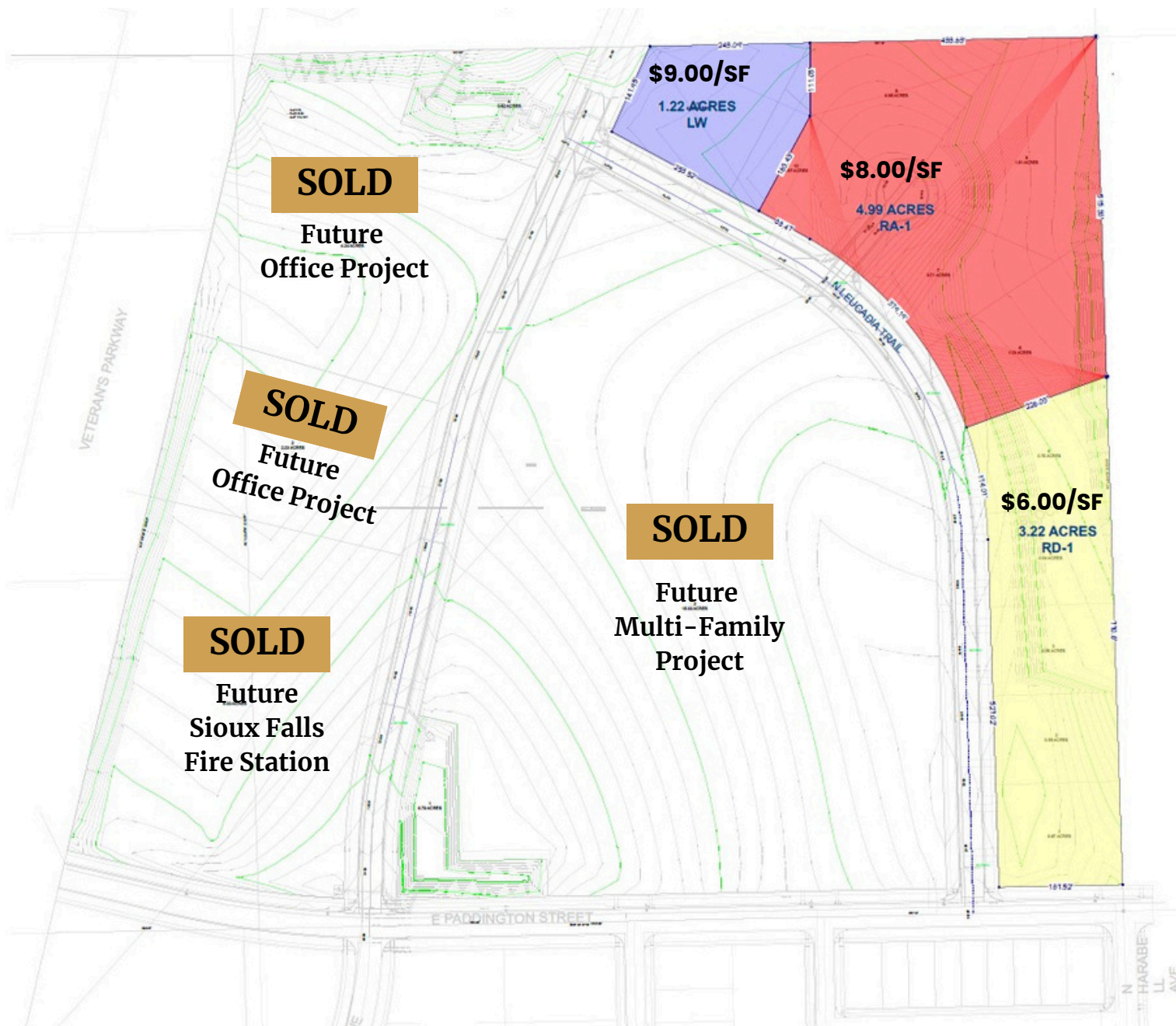

MAPLEVIEW LAND



CONCEPT LAYOUT FOR MULTI-FAMILY LAND



MAPLEVIEW LAND



LIVE-WORK & MULTI-FAMILY/TWINHOME LAND

