

**FOR LEASE**



# SOUTHWAY CENTER

RETAIL SPACE

**Bender**  
COMMERCIAL

 **2117 SOUTH MINNESOTA AVENUE**  
**SIOUX FALLS, SD**  **3,445 SF**  **\$9.00/SF NNN**  
**EST NNNs: \$3.77/SF**

- Retail space available in the Southway Center along high traffic Minnesota Avenue.
- Open showroom area with private office and breakroom.
- Great visibility with a daily traffic count of over 45,000 vehicles.
- Building signage available.
- Additional parking available on the west side of the building.

**ANDI ANDERSON, SIOR** | [andi@benderco.com](mailto:andi@benderco.com) | 605-782-1660



Bender Commercial Real Estate Services | 305 West 57th Street | Sioux Falls, SD 57108 | 605-336-7600 | [benderco.com](http://benderco.com)

© 2024 Bender Companies. Information herein deemed reliable, but not guaranteed.



# SOUTHWAY CENTER



## RETAIL SPACE FOR LEASE





# SOUTHWAY CENTER



## RETAIL SPACE FOR LEASE

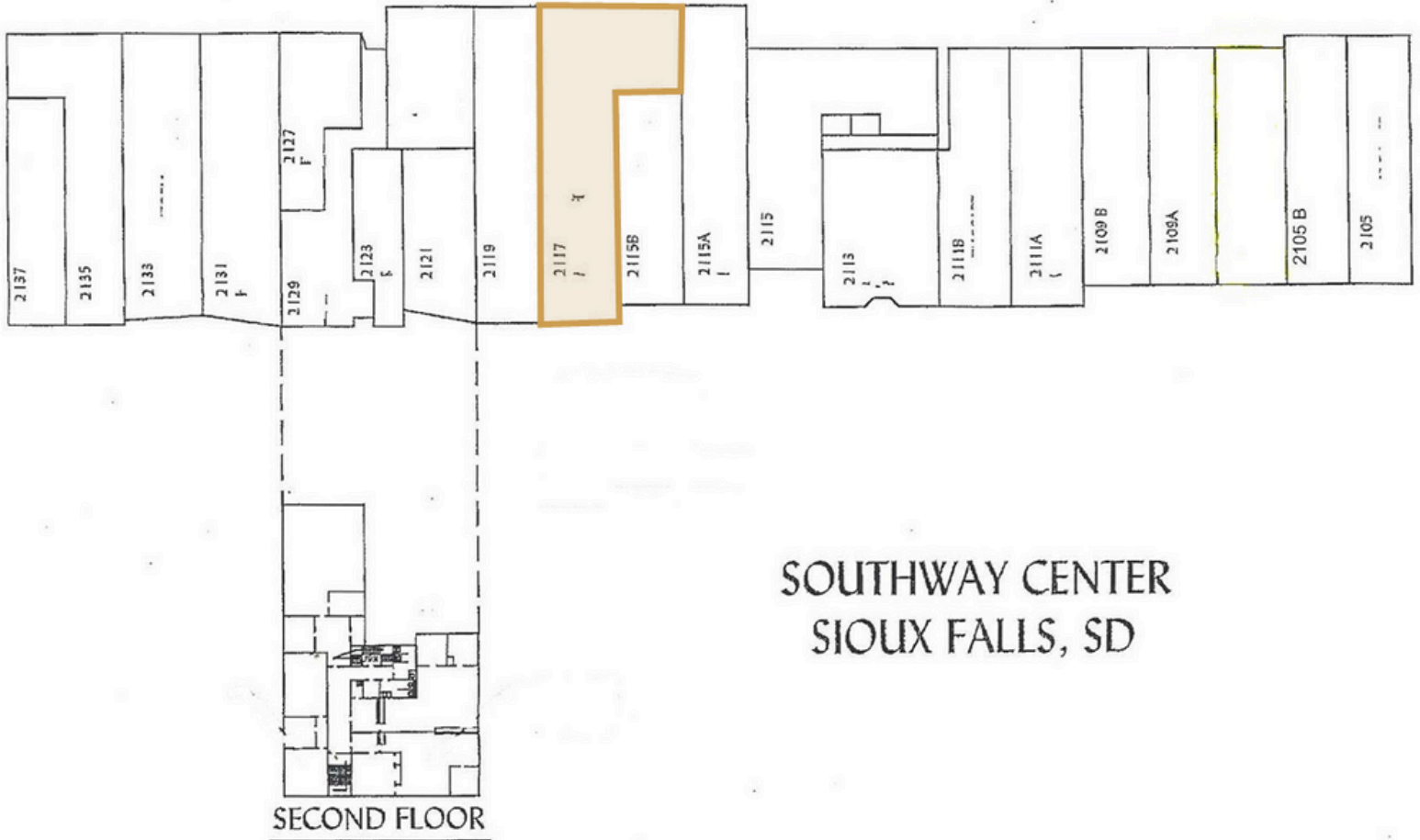



# SOUTHWAY CENTER



RETAIL SPACE FOR LEASE





# SOUTHWAY CENTER



## RETAIL SPACE FOR LEASE

